



EQUIPMENT, INC

### FOOD SERVICE LINE OF QUALITY PRODUCTS

Item No. \_\_\_\_\_

### MODEL: FFS-1 VERTICAL FORM/FILL/ SEAL MACHINE

AIA 11400—FOOD SERVICE EQUIPMENT



#### HOW IT WORKS

The TUCS vertical form/fill/seal machine uses a roll of film and forms a pouch. The bag is filled with product from a piston filler or hopper and is heat sealed to produce an extremely durable food package.

#### DESIGN ADVANTAGES

- **Manual pouch filling versus automatic machine** while (1) operator can safely pump and fill pouches, the process is speeded up (to save on time for kettle turns) by using (2) operators—especially with 75 gallon and larger loads. Larger volume operations should consider the Tucs Model FFS-1—a form/fill/seal machine which uses roll stock to continuously form pouches; fill the pouch with the exact quantity; squeezes out the trapped air and makes a heat seal closure before detaching the filled pouch from the roll stock.
- **Accuracy** is in grams per filled pouch
- **Compact Design**—requires smallest floor space. Low height for changing rollstock
- **Changeover**—Quick change of forming shoulder (minutes) - No time loss in each size of fill volume—No tools required
- **Roll Stock**—Barrier film of cross linked materials for hot or cold filling
- **Seals** - Done by heat sealing - No clips allows complete in-line metal detection (option for Q.C)
- **Savings**—Less waste per pouch versus ready made casings and clip technique—See separate Savings Section for example
- **Repeatable**—Proven in millions of cycles
- **Giveaway**—NONE—When coupled with Tucs Piston Volumetric Pump and compared to other pump filler models.



#### SPECIFICATION

The TUCS Vertical Form/Fill/Seal Machine with integrated controls offers the benefits of high-production volumes with simple trouble-free operation. The system can be used for a very broad range of products such as hot and cold fills of:

- Soups and sauces
- Chili and taco meat
- Any pumpable products

The machine runs 2 oz. to 20 lb. packages at 60 to 10 cycles per minute.

#### CONSTRUCTION AND CONTROLS

Corrosion resistant 316 stainless steel frame C/W custom operator interface unit

#### FEATURES

- Will seal laminated or co-extruded film
- Hose-down easily cleanable
- Fold-out control panel (NEMA 4)

The F/F/S Machine is U.S.D.A listed and built to F.D.A. standards.



EQUIPMENT, INC

5301 Industrial Blvd., Suite 200  
Fridley, MN 55421

Phone: (763) 574-7475

Fax: (763) 574-7472

Email: martytucs@tucsequipment.com

# MODEL: FFS-1 VERTICAL FORM/FILL/SEAL MACHINE

Optional  
Out-Conveyer  
8 Foot Standard,  
Custom Lengths

Operator Display  
(rotates viewing and  
access)

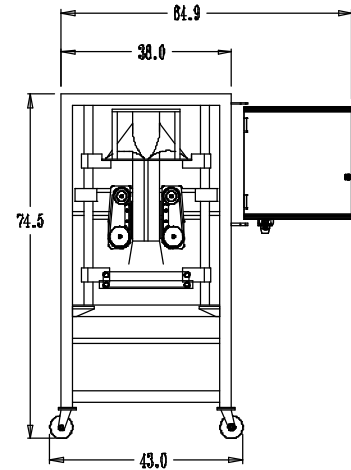
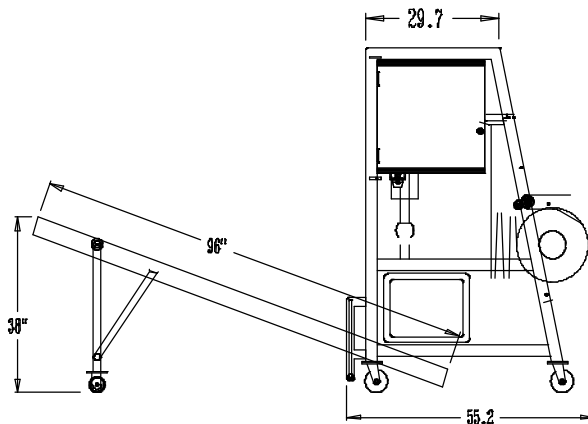
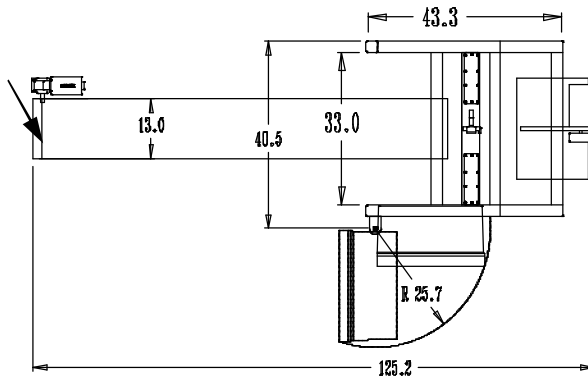

MODEL	WORK CAP.
FFS-1	Contact Factory

## UTILITY REQUIREMENTS

A= Air Pressure, 80 PSI min  
1/4 NPT Hookup

V= Electricity  
208 or 240 Volts, Single phase  
20 Amps

## SPECIFICATION

Shall be a TUCS Model FFS-1, Form/fill/Seal/ Machine. 316 Stainless Steel Tube Construction, Air Reservoir, with Filter/Regulator. Air-over-Oil Web tracking system. Fixed Pouch Spreaders. Adjustable Tension Roller Bar. Forming Shoulder built for Lap Seal. Velcro Wear Strips. PLC controls with rotating interface. Lexan Doors with Magnetic Switches. Locking Swivel Castors. 9.75 Wide Pouch Shoulder Standard.

## OPTIONS

- 8' Exit Conveyor
- Custom sized exit conveyors
- 230mm, 350mm, 420mm, 510mm or custom forming shoulders



5301 Industrial Blvd., Suite 200  
Fridley, MN 55421

Phone: (763) 574-7475  
Fax: (763) 574-7472  
Email: martytucs@tucsequipment.com